

LED Strips

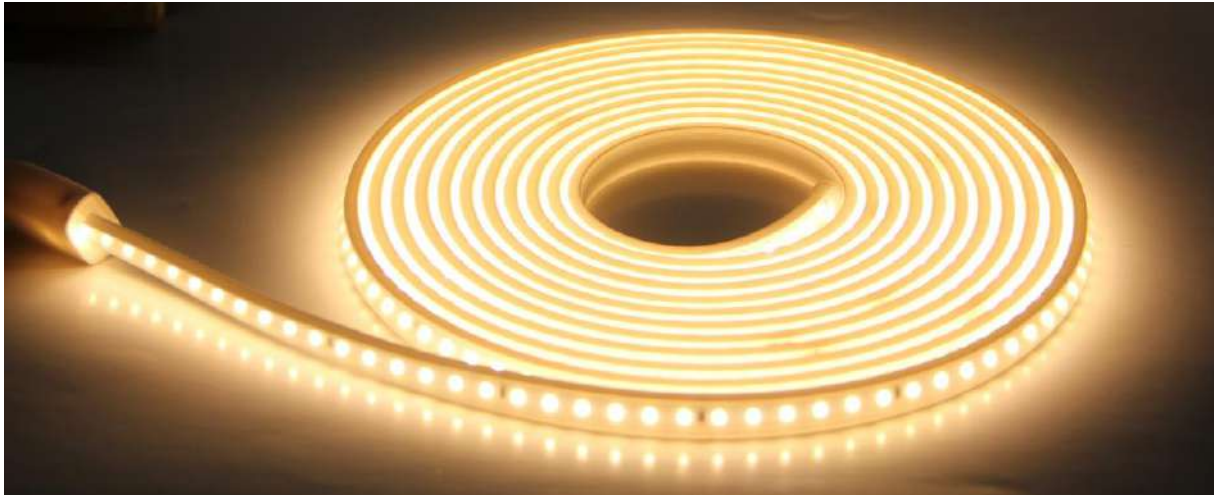

Benefits:

- For indoor & outdoor use
- Up to 15.5W/m & 1650lm
- Up to 80% energy saving
- Lower maintenance cost
- UV & IR free light
- CRI>80
- IP20, IP40, IP44, IP65
- 120V or 220V, 24V, or driverless (direct voltage)
- 2700K to 6500K

Applications:

- Linear light
- Indirect lighting
- Shops, stores
- Residential
- Restaurants, bars
- Hotels
- Garden, outdoor
- Offices



General Characteristics:

| Item | Watt/M | Lumen/m | Voltage | CCT (K) | LED pcs/m | m/roll | Min. Cut Length |
|----------------------------------|--------|---------|----------|-------------|-----------|--------|-----------------|
| 120V/220V IP20 | | | | | | | |
| TLLSE-5 | 5W | 400lm | 120/220V | 2700K-6500K | 60 | 5m | 1m |
| TLLSE-8 | 8W | 700lm | 120/220V | 2700K-6500K | 120 | 5m | 1m |
| TLLSE-12 | 12W | 1050lm | 120/220V | 2700K-6500K | 180 | 5m | 1m |
| 24V IP44 | | | | | | | |
| TLLSE-5.5 | 5.5W | 550lm | 24V | 2700K-6500K | 60 | 5m | 5cm |
| TLLSE-8 | 8W | 850lm | 24V | 2700K-6500K | 120 | 5m | 5cm |
| TLLSE-12 | 12W | 1100lm | 24V | 2700K-6500K | 120 | 5m | 5cm |
| TLLSE-15.5 | 15.5W | 1500lm | 24V | 2700K-6500K | 120 | 5m | 5cm |
| 24V IP65 | | | | | | | |
| TLLSE-5.5 | 5.5W | 500lm | 24V | 2700K-6500K | 60 | 5m | 5cm |
| TLLSE-8 | 8W | 800lm | 24V | 2700K-6500K | 120 | 5m | 5cm |
| TLLSE-12 | 12W | 1000lm | 24V | 2700K-6500K | 120 | 5m | 5cm |
| TLLSE-15.5 | 15.5W | 1400lm | 24V | 2700K-6500K | 120 | 5m | 5cm |
| Driverless 120V/220V IP40 | | | | | | | |
| TLLSE-12 | 12W | 1300lm | 120/220V | 2700K-6500K | 120 | 50m | 10cm |
| TLLSE-15 | 15W | 1650lm | 12V/220V | 2700K-6500K | 120 | 50m | 10cm |

LED Strips

Neon Flex

Our LED Neon Flex Strip is a perfect way to give a continuous smooth, linear lighting effect. It is easy to cut, bend and install. Its flexibility can make it easy to bend it into whatever angle or shape needed. This linear light is made of an inner plastic extrusion that houses the series of LED and a plastic outer jacket protecting the inner core. The plastic jacket is translucent colored and the LED's can be in different colors (red, orange, blue, yellow, green, etc) and white tones.

Benefits:

- For indoor & outdoor use
- Flexible
- Low heat & safe
- Up to 80% energy saving
- Lower maintenance cost
- UV & IR free light
- CRI>80 or CRI>90
- 50.000 hrs life-span
- Single or double side light emission

Applications:

- Reading & task lighting
- Cove lighting
- Accent lighting
- Edge lighting
- Under counter lighting
- Stair lighting

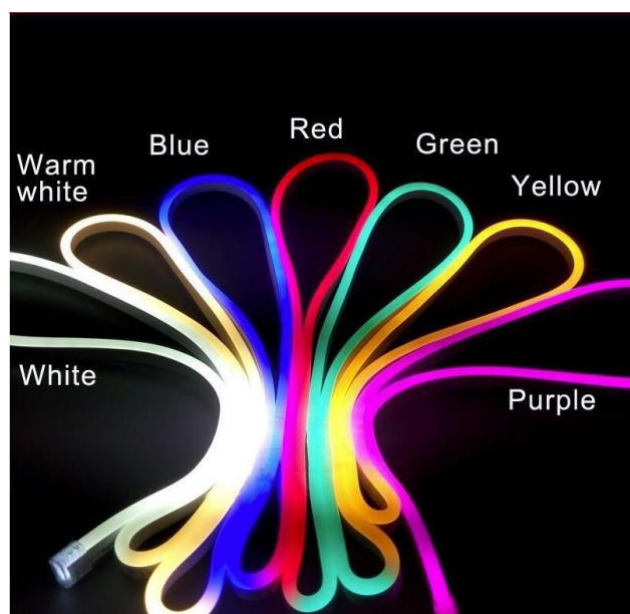
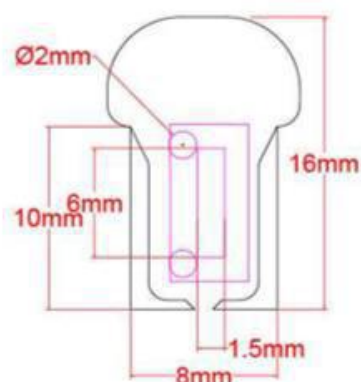

Characteristics:

- 12V, 24V, 120V, 220V, OR 277V*
- Working am: 15-17mA/meter (220V)
- LED number: 120 LEDs/meter for single colored – 60 LEDs/meter for RGB
- LED: SMD 2835
- Colors: White, warm white, red, green, blue, yellow, pink, purple, RGB
- Beam angle: 120°
- Operation temp.: -40°C up to 80°C
- Body temp.: 40°C up to 60°C
- IP65, IP67*, IP68*
- Shell material: Integration D shaped PVC
- Accessories: Power cord, male-male plug, U aluminum channel or U PVC channel, metal pin, connector, heat shrink cap, end cap, controller

Power/M:

- Red, Yellow, Blue, Green, White, Warm White, Purple
 - AC220V + 110V – 6W/M
 - DC24V + 12V – 8W/M
- RGB
 - AC220V + 110V – 6W/M
 - DC24V – 11W/M

Cutting:

- Red, Yellow, Blue, Green, White, Warm White, Purple
 - AC220V – 100cm
 - AC110V – 50cm
 - DC24V – 50cm
 - DC12V – 5cm
- RGB
 - AC220V – 100cm
 - AC110V – 50cm
 - DC24V – 50cm

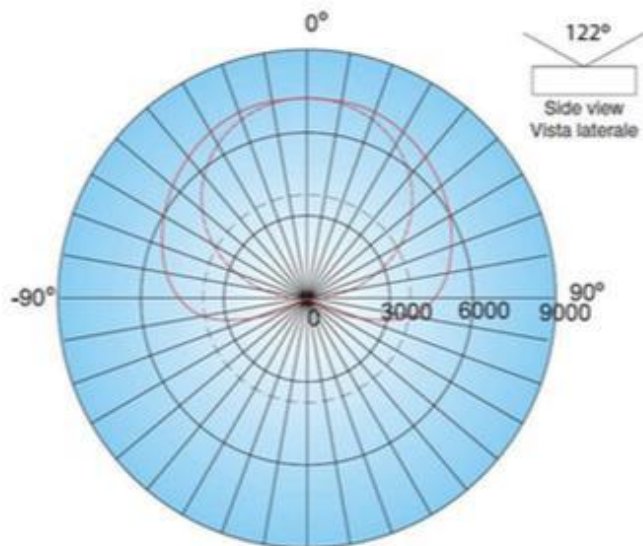
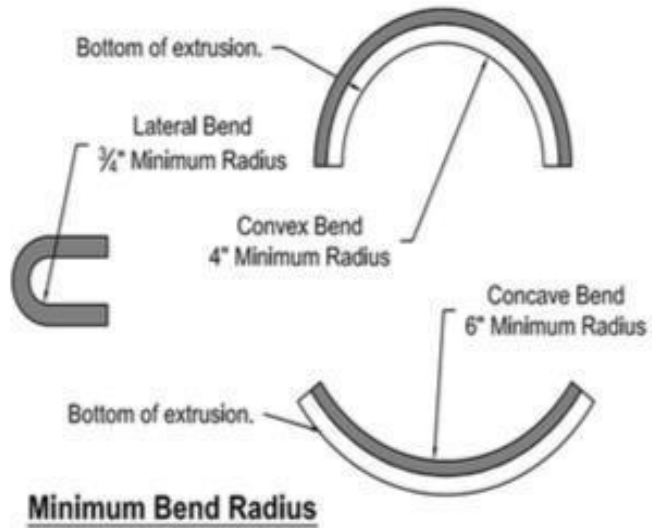

*Photos, descriptions and details of the product are subject to change without previous notice.

*277V special upon request. Size 14*26mm.

*Strip is IP68 excluding the connection part to the power cord (IP65).

*After cutting strips & re-wiring, the cuttable point becomes IP65.

*Most suitable & recommended for use as IP65.

LED Strips

Neon Flex 360° Omni-Directional

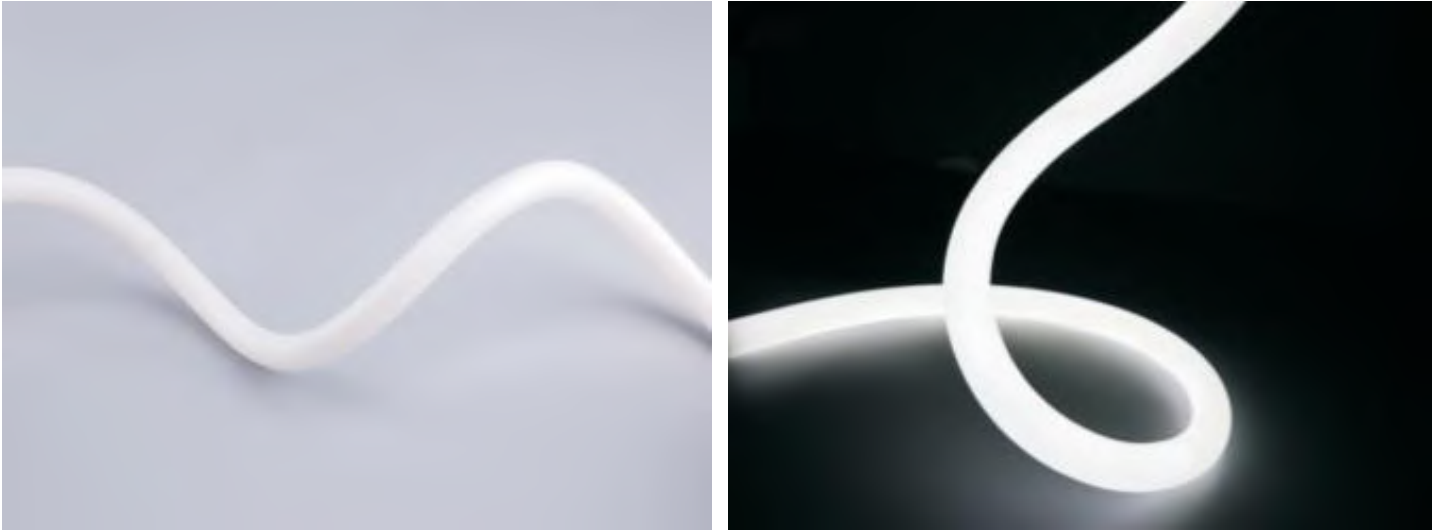

Benefits:

- Circular tube design with omni-directional 360 degrees light emission
- Uniform, dot-free light effect
- Smooth & comfortable light performance
- Up to 5 meters long
- Cuttable with end cap glue sealing or die-casting process
- Dimmable with PWM also available
- Silicon extrusion technology, highly efficient & environment-friendly
- High grade appearance, soft bend flexibility, strong impact & weather resistance
- Surface mount or ceiling installation by bracket or clip
- Suspension installation by using an extra suspension kit
- Diameter of 18mm
- IP65



Characteristics:

- 12W/m
- 24V DC
- 2700K to 6500K
- 1150lm/m
- 96lm/W
- SMD2216
- CRI80
- 480LED/m
- Working temperature: -20C to 45C
- Storage temperature: -20C to 60C
- 50.000 hrs for indoor & 36.000 hrs for outdoor

(1) Power cable in rear feed.



(2) Surface mounting by bracket.

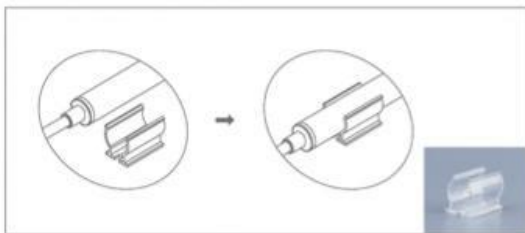

(3) Surface mounting or ceiling mounting by clip.

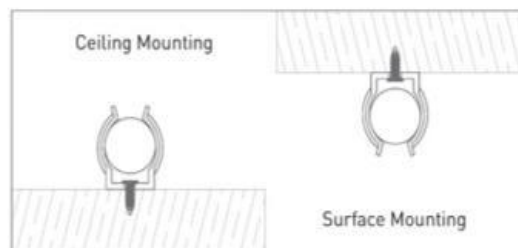
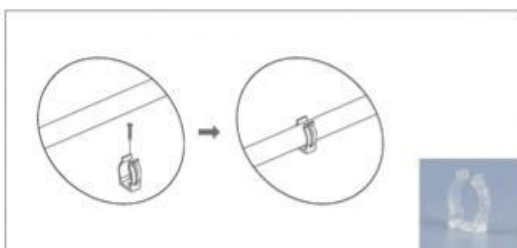

[4] Ceiling mounting by suspension kit.

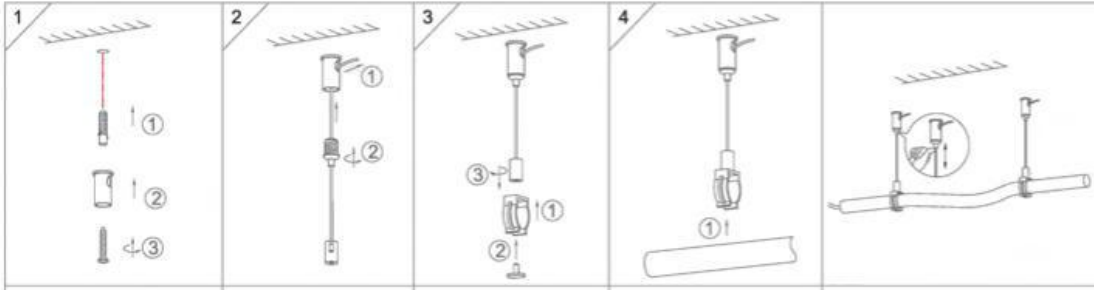

Cautions:

- Please read the contents on the box and label carefully before installation.
- Check if the specification e.g. voltage, current etc meet the requirements.
- Power must be cut off before installation, replacement and cleaning.

Remarks:

- Power consumption tolerance: +/- 10%.
- Luminous flux & cd tolerance: +/-10%.

LED Strips

Neon Flex D Series



Features:

- Uniform, dot free, smooth & comfortable light up to 20 mts length
- Silicon extrusion technology with high efficiency
- Soft bend flexibility, strong impact resistant
- Wide beam angle light distribution
- IP65 with gluing process for outdoor use
- IP40 without gluing process for indoor use
- Lower maintenance cost
- UV & IR free light
- CRI>80
- 50.000 hrs lifespan for indoor use
- 36.000 hrs lifespan for outdoor use
- Free cutting to any length required
- White CCT or RGB
- Different installation methods & accessories available
- Top & side bend

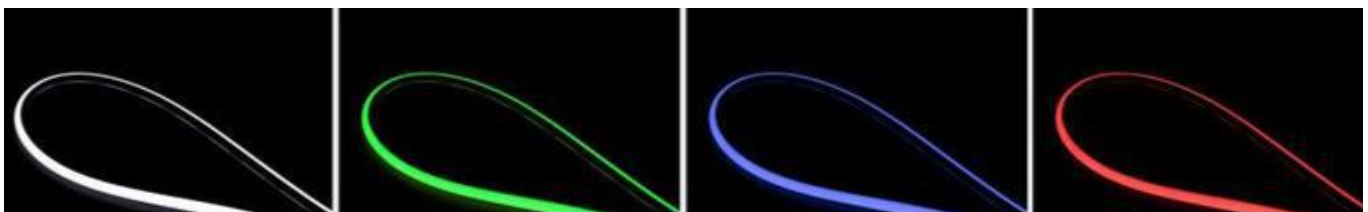

Characteristics:

- 9W/m, 14W/m
- 24V
- 2700K-6000K
- Red, green, blue, pink or RGB
- SMD3528 or SMD4040
- 120 LEDs/m
- Dimensions:
W:16mm H:15mm
W: 10mm H:20mm
- Maximum length: 20 mts
- Operating temperature: -20°C to 45°C
- L70B50 @ Tc max. 65°C (LED pin temperature)
- Up to 900-1000lm/m
- 120°/180°

- Free cutting in any position and



- Different directions for power feeds



- Joint connector available



- Jumper accessories



Installation:

- Clip & screw

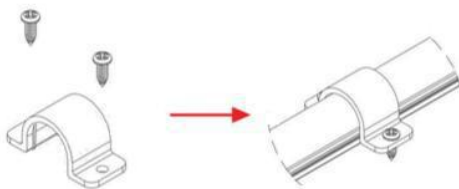

- Bracket & screw

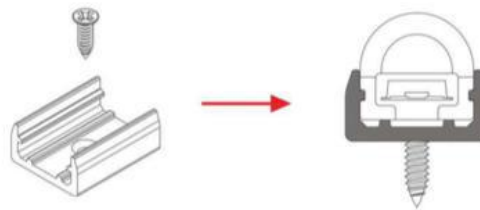

- Aluminum & screw

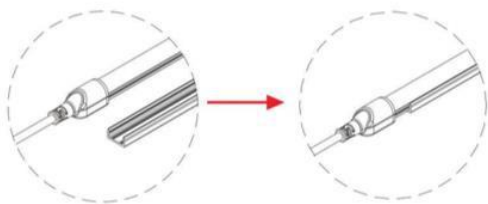

- Fixed bendable bracket

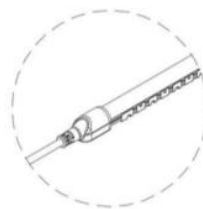

Remarks:

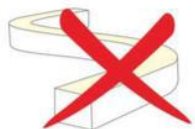
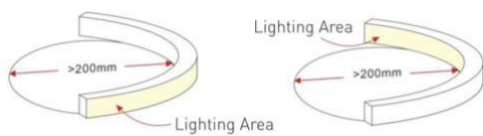

LED Strips

Neon Flex P Series



Features:

- Flat LED profile offering uniform, dot free, smooth & comfortable light up to 20 mts length
- Silicon extrusion technology with high efficiency
- Soft bend flexibility, strong impact resistant
- Wide beam angle light distribution
- IP65 with gluing process for outdoor use
- IP40 without gluing process for indoor use
- Lower maintenance cost
- UV & IR free light
- CRI>80
- 50.000 hrs lifespan for indoor use
- 36.000 hrs lifespan for outdoor use
- Free cutting to any length required
- White CCT or RGB
- Different installation methods & accessories available
- Top & side bend



Characteristics:

- 9W/m, 14W/m
- 24V
- 2700K-6000K
- Red, green, blue, pink or RGB
- SMD3528 or SMD4040
- 120 LEDs/m
- Dimensions:
W:16mm H:12mm
W: 8.8mm H:16.5mm
- Maximum length: 20 mts
- Operating temperature: -20°C to 45°C
- L70B50 @ Tc max. 65°C (LED pin temperature)
- Up to 700-800lm/m
- 120°

- Free cutting in any position and



- Different directions for power feeds

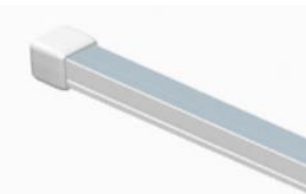
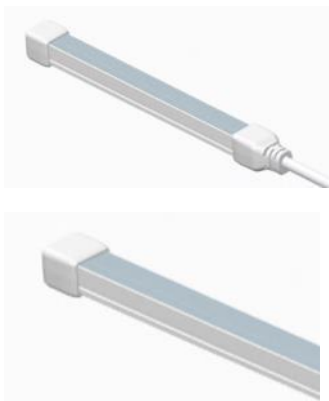

- Jumper accessories



Installation:

- Clip & screw

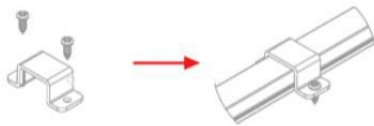

- Bracket & screw

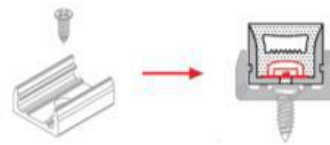

- Aluminum & screw

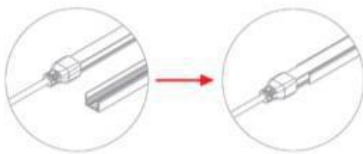

- Fixed bendable bracket



Remarks:

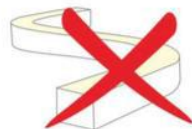
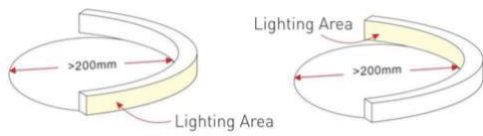

LED Strips

Neon Flex Ultra Long IF Series



Benefits:

- Ultra long run LED strip with excellent bending resistance
- Up to 50 meters run length with no brightness difference
- Great heat dissipation using reinforced built-in protective plate
- Environmentally friendly, weather resistant & high-quality food grade silicone
- Simple appearance & soft touch with dust proof matte finish coating
- Top or side bend
- White
- IP67 or IP68
- High impact resistance IK08
- Dimmable with PWM signal
- 50000 hrs lifespan
- CE/UL/RoHs

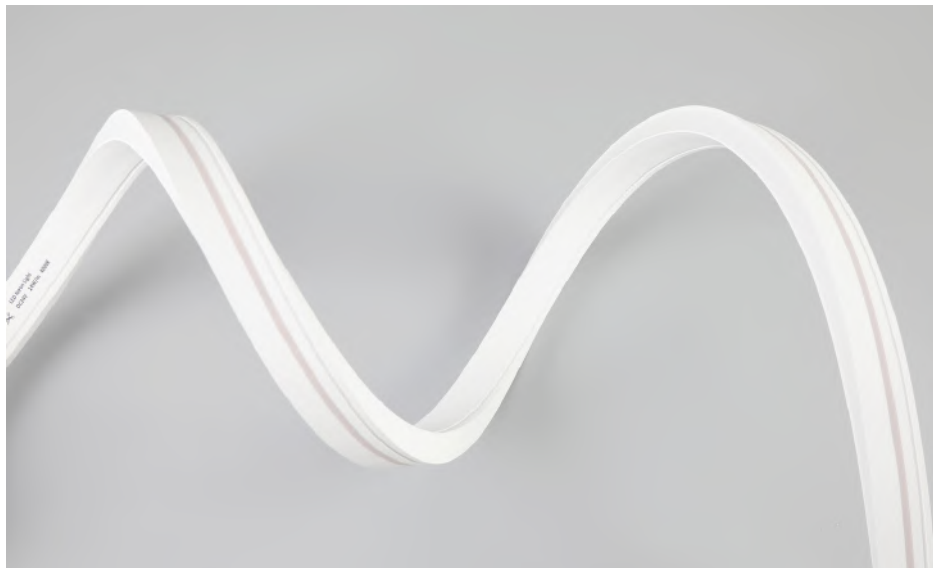

Characteristics:

- 4.8W/m, 9.6W/m, 14W/m
- 2700K, 3000K, 4000K, 5000K, 6000K
- CRI80 or CRI90
- DC24V/48V
- Brightness **4000K CRI80 top bend**
280lm/m, 560lm/m, 820lm/m
- Brightness **4000K CRI90 top bend**
240lm/m, 480lm/m, 700lm/m
- Brightness **4000K CRI80 side bend**
190lm/m, 380lm/m, 560lm/m
- Brightness **4000K CRI90 side bend**
160lm/m, 320lm/m, 480lm/m
- SMD2835
- 120LED/m
- 120°
- Top bend dimension W16xH16mm
- Side bend dimension W11.5x20mm

Cautions:

- Please read the contents on the box and label carefully before installation.
- Check if the specification e.g. voltage, current etc meet the requirements.
- Power must be cut off before installation, replacement and cleaning.

Remarks:

- Power consumption tolerance: +/- 10%.
- Luminous flux & cd tolerance: +/-10%.

LED Strips 3D Neon Light



Benefits:

- 3D omni directional illumination with wide beam angle offering a 3D vivid performance
- Perfect for surface or flush mounting applications with plane profile
- For indoor or outdoor areas
- Smooth & comfortable light
- Field cuttable & assembly to the desired length
- Top bend
- 5M, 10M, 50M
- White, CCT, RGB, RGBW
- 14W/m



Characteristics:

- 14W/m
- 24V DC
- 2700K to 6000K, CCT adjustable from 2700K to 6000K, RGB, RGBW
- 13400lm/m
- CRI80 or CRI90
- 120LED/m, 240LED/m, 96LED/m
- Working temperature: -20C to 45C
- Storage temperature: -20C to 60C
- 50.000 hrs
- 5m, 10m, 50m long
- IP67
- IK06
- SMD2835, SMD4040
- W16xH16mm



Cautions:

- Please read the contents on the box and label carefully before installation.
- Check if the specification e.g. voltage, current etc meet the requirements.
- Power must be cut off before installation, replacement and cleaning.

Remarks:

- Power consumption tolerance: +/- 10%.
- Luminous flux & cd tolerance: +/-10%.

LED Strips Neon Black

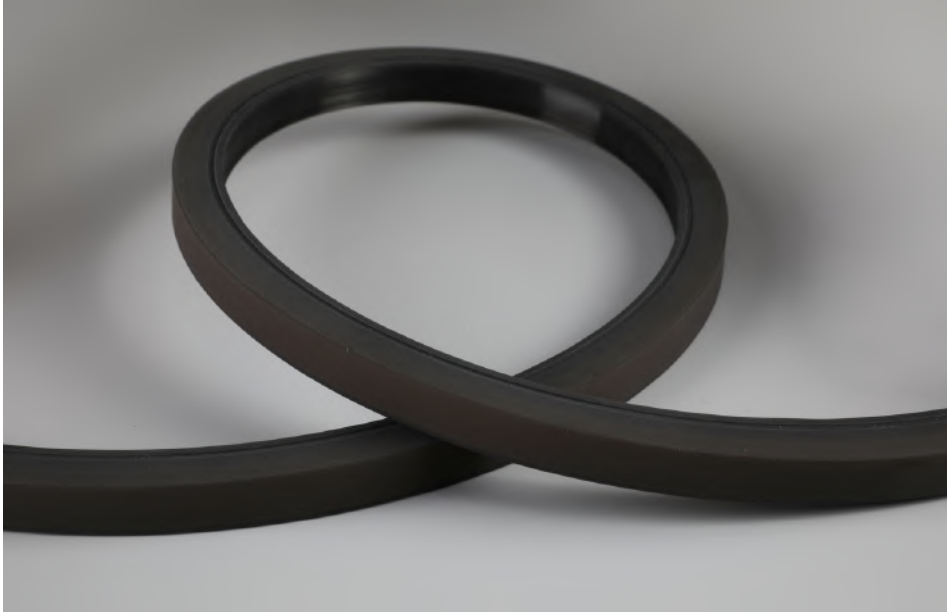

Benefits:

- LED neon strip with black color jacket
- Perfect for applications with black material or finishing
- 3- or 4-sided black color
- Plane profile allowing surface mount or recessed installation
- Uniform, dot free, smooth lighting up to 5m
- On field cuttable
- Dimmable available with PWM signal
- High grade appearance, soft bend flexibility, strong impact and weather resistance
- 50000 hrs lifespan

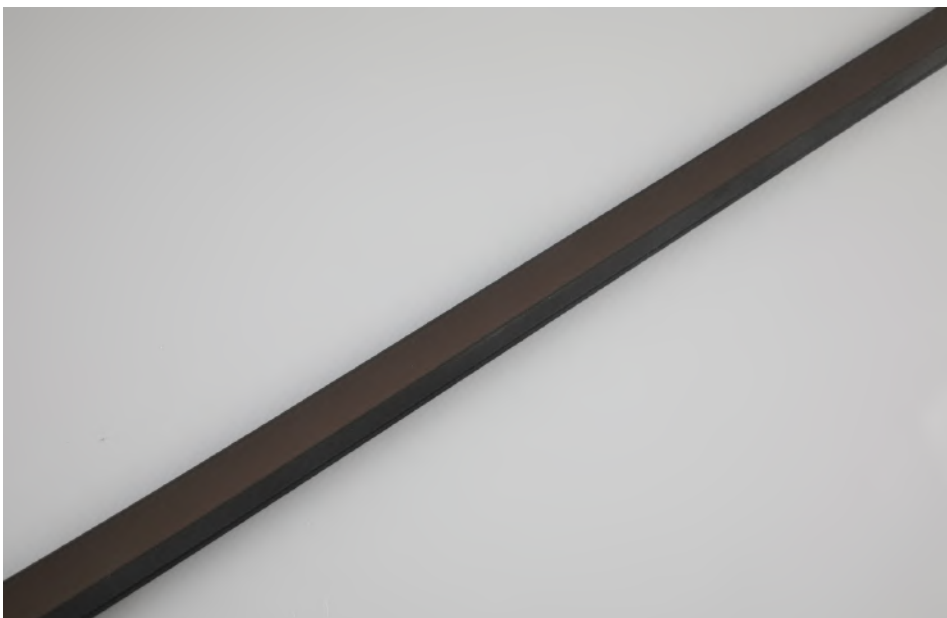

Characteristics:

- 8W/m, 14W/m
- 24V DC
- 2700K to 6000K, CCT adjustable from 2700K to 6000K, RGB, RGBW
- 760lm/m
- CRI80 or CRI90
- Working temperature: -20C to 45C
- Storage temperature: -20C to 60C
- 5m, 10m, 50m long
- IP67
- IK06
- SMD2835, SMD5050
- W10xW10mm, W16xH16mm
- 120°

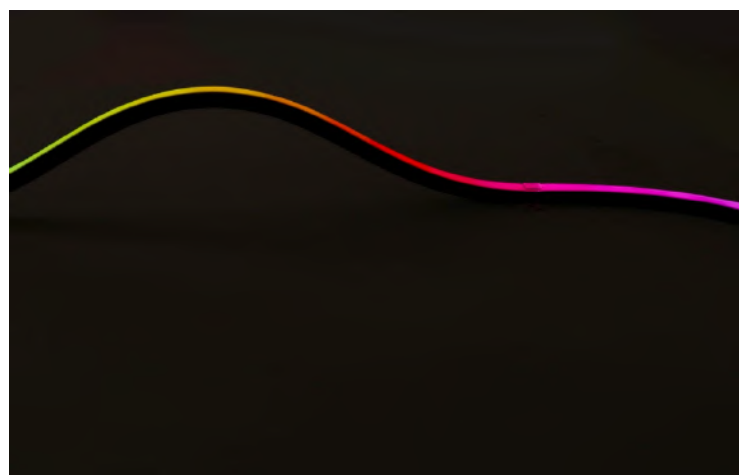
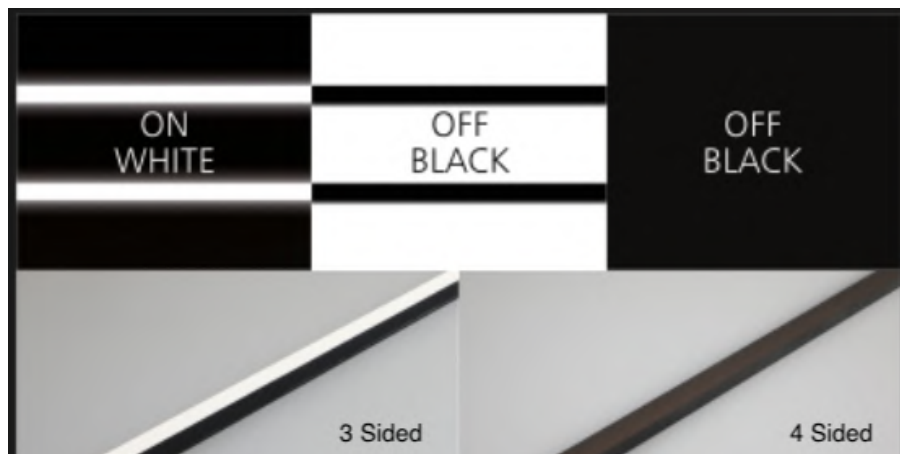

Cautions:

- Please read the contents on the box and label carefully before installation.
- Check if the specification e.g. voltage, current etc meet the requirements.
- Power must be cut off before installation, replacement and cleaning.

Remarks:

- Power consumption tolerance: +/- 10%.
- Luminous flux & cd tolerance: +/-10%.

LED Strips

IP68

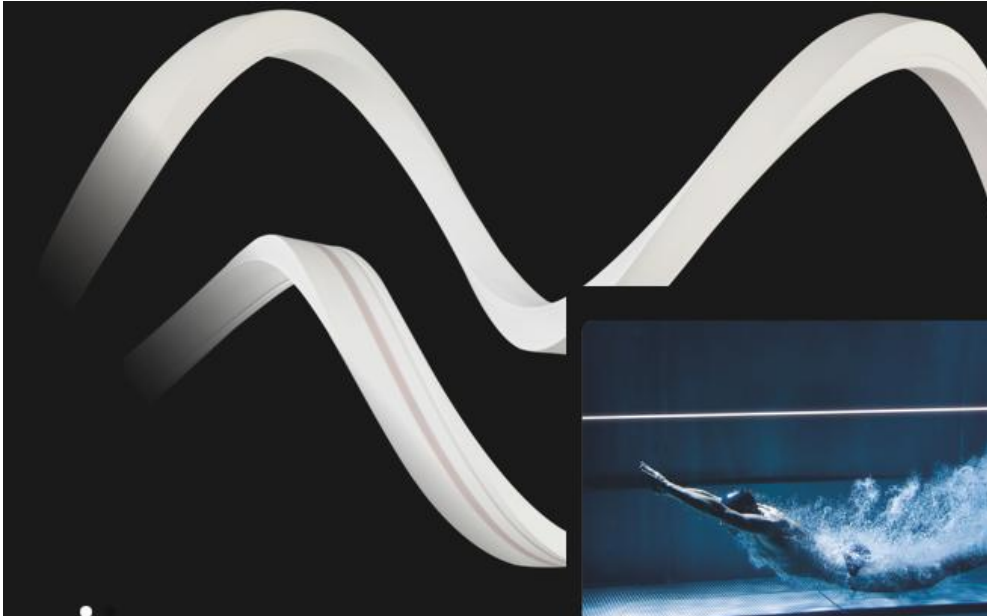

Benefits:

- IP68 waterproofing LED strip
- Perfect for underwater immersible applications, swimming pools, spas, landscape pools, fountains, waterfalls, modern showers
- Compact & sturdy structural design with IK08 impact resistance
- Dust proof matte finishing coating
- Consistent & homogenous lighting performance
- Excellent silicone material with high water resistance & chemical stability
- Dimmable available with PWM signal
- 50000 hrs lifespan



Characteristics:

- 12W/m, 14W/m
- 24V DC
- 2700K to 6000K, CCT adjustable from 2700K to 6000K, RGB, RGBW
- 820lm/m
- CRI80 or CRI90
- 5m
- IP68
- IK08
- SMD2835, SMD4040
- W11.5xH20mm, W16xH16mm
- 120°

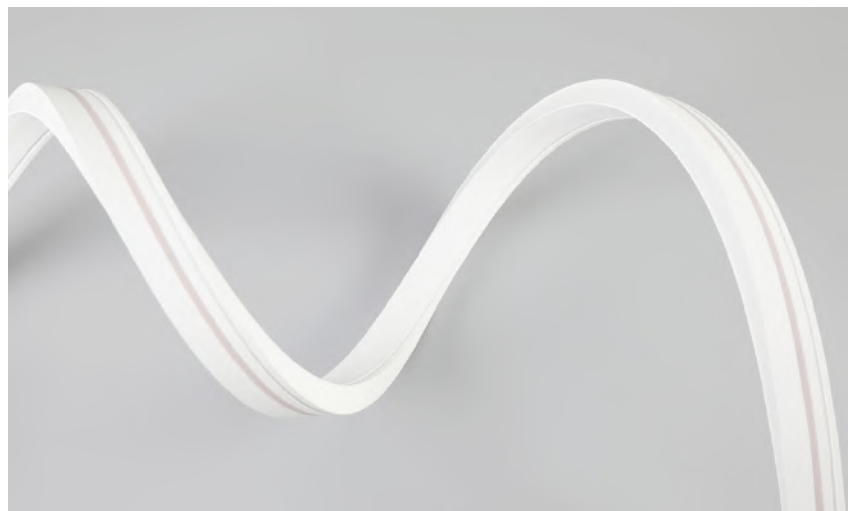

Cautions:

- Please read the contents on the box and label carefully before installation.
- Check if the specification e.g. voltage, current etc meet the requirements.
- Power must be cut off before installation, replacement and cleaning.

Remarks:

- Power consumption tolerance: +/- 10%.
- Luminous flux & cd tolerance: +/-10%.